

Community Viability Committee

**Councillor Mike Petryna, Chair
Councillor Louise Portelance, Vice-Chair**

Request for Recommendation Priorities Committee



Type of Decision

Meeting Date	October 23, 2002				Report Date	October 17, 2002			
Recommendation	<input checked="" type="checkbox"/>	Yes		No	Priority	<input checked="" type="checkbox"/>	High		Low
	Direction Only				Type of Meeting	<input checked="" type="checkbox"/>	Open		Closed

Sub-Committee Check-Off

Please indicate which sub-committee will deal with this issue

<input checked="" type="checkbox"/>	Community Viability		Public & Intergovernmental Affairs		Financial & Program Accountability
-------------------------------------	---------------------	--	------------------------------------	--	------------------------------------

Report Title

Rainbow Outlet Centre, Request for Access, Elm Street

Policy Implications + Budget Impact

This report and recommendation(s) have been reviewed by the Finance Division and the funding source has been identified

Background attached

Recommendation

That Rainbow Outlet Centre, 40 Elm Street, Sudbury, be granted a right-in only entrance off of Elm Street to accommodate a lay-by drop off zone, and internal road connection to a parking lot at the north east corner of Durham and Beech Streets.

Recommendation attached

Recommended by the General Manager

D. Bélisle
General Manager of Public Works

Recommended by the C.A.O.

M. Mfeto
Acting Chief Administrative Officer

Report Authored By



D. Bélisle
General Manager of Public Works

Division Review

The Rainbow Outlet Centre, formerly City Centre, has requested right-in only as well as right-out only driveways off of Elm Street to accommodate a lay-by drop off zone as well a road access to the parking lot located at the corners of Durham and Beech Streets.

Elm Street is designated a Primary Arterial Road, with the following access restrictions:

- Intersections with other arterial roads
- Intersections with collector roads
- Driveways to major regional activity centres

Staff have reviewed this request for right-in and right-out driveways, and are of the opinion that a right-in only driveway could be accommodated, but that the right-out driveway would cause conflict with through traffic on Elm Street, and to some degree, pedestrian traffic would also be affected.

The enclosed sketch depicts a two-lane lay-by, with the right-in and right-out driveways. The southerly lane of the lay-by is on City property, and in order to transfer any land to the abutting property owner, the City must advertise and ultimately declare it as surplus land before it can be sold. That being the case, the two-lane lay-by cannot be constructed this fall, but the owner wishes to proceed with a single lane lay-by, on private property this year, followed up with the two-lane expansion after the property has been acquired.

October 16, 2002

VIA FACSIMILE: 671-8118

City Of Greater Sudbury
200 Brady Street
Sudbury, Ontario
P3A 5P3

Attention: Thom Mowry - City Clerk

Reference: Agenda - Committee of Priorities

Dear Mr. Mowry:

In conversation with Austin Davey and Mike Petryna; they have suggested that we appear before the Committee of Priorities to deal with the issue of the proposed driveway and lay-by to be constructed on the front courtyard of the Rainbow Outlet Centre.

Since there is a degree of urgency if the construction is going to proceed this season, we would ask that you add this matter to the agenda for the meeting scheduled for Thursday October 17, 2002. Please confirm if you are able to accommodate.

Thank you for your anticipated co-operation.

Yours truly,

VISTA SUDBURY HOTEL INC.



Ray Hirani



RAINBOW OUTLET CENTRE

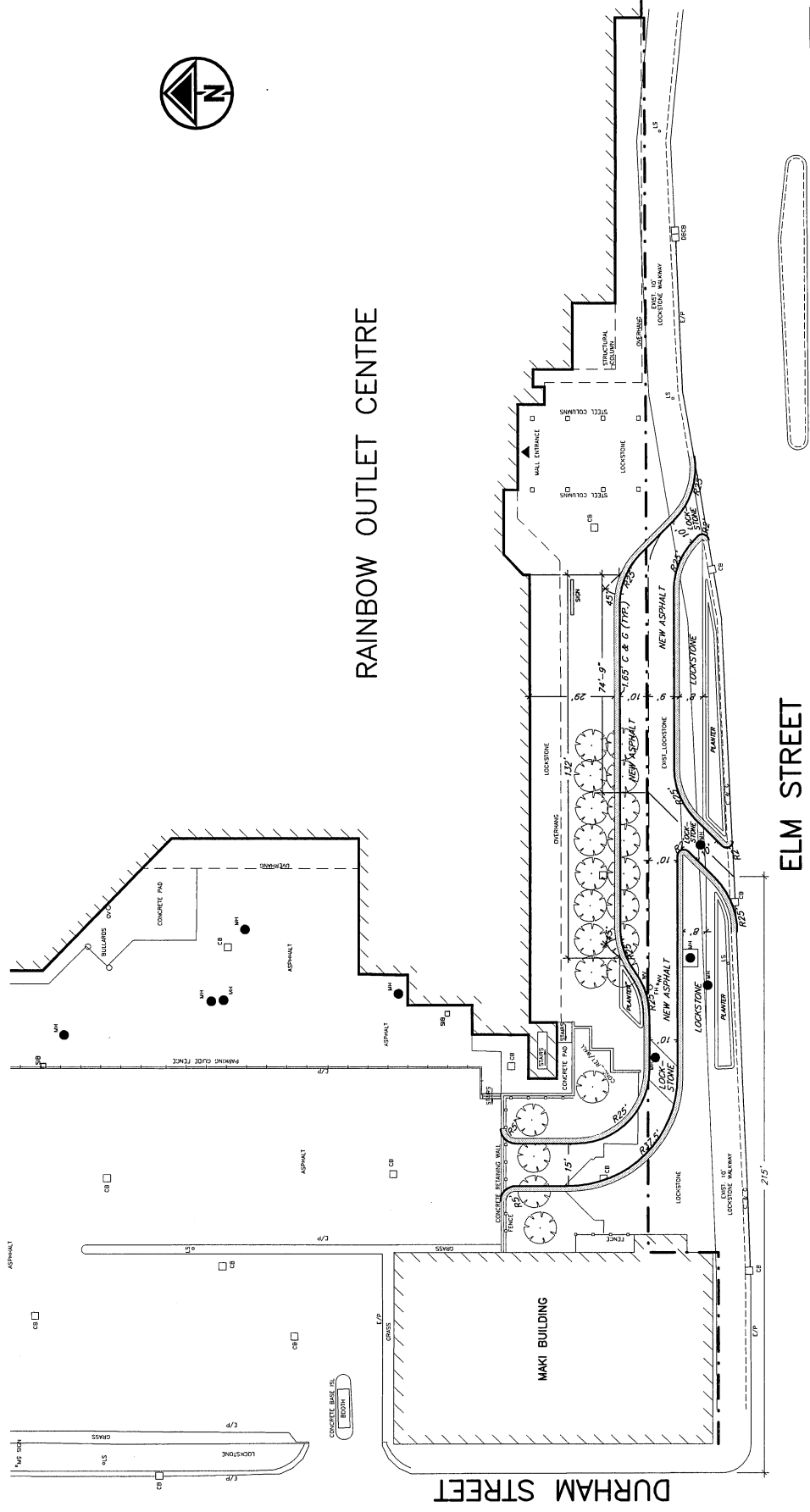

RAINBOW OUTLET CENTRE EXTERIOR RENOVATIONS	
PROPOSED ELM STREET IMPROVEMENTS	
CASTELLAN LUCIW JAMES + ARCHITECTS INC 248 CEDAR STREET SUDBURY ONTARIO P0B 1M6 TEL: 705-874-2300 FAX: 705-874-2183	
northland engineering (1987) limited Consulting Engineers and Planners	
DRAWN BY: N.E.L.	DATE: OCT 19/02
CHECKED BY: T.S.A.	SCALE: N.T.S.
FIELD BOOK:	PROJECT NO. DRAWING NO.
OFFICE SU-3395	SU-3395 1 of 2
	REV. 0

24



RAINBOW OUTLET CENTRE

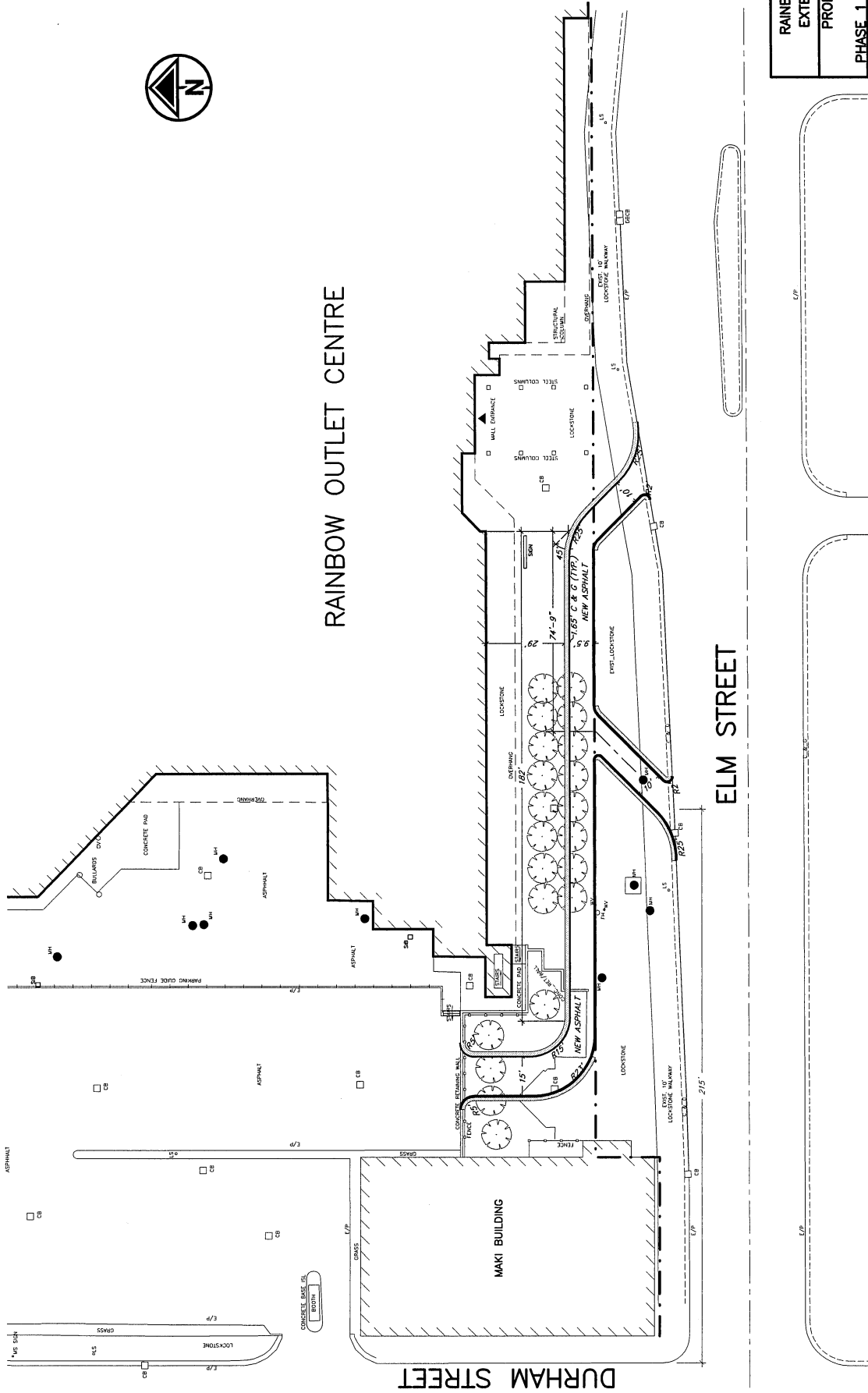

RAINBOW OUTLET CENTRE EXTERIOR RENOVATIONS	
PROPOSED ELM STREET IMPROVEMENTS PHASE 1 - 2002 CONSTRUCTION	
CASTELLAN LUCI W JAMES + ARCHITECTS INC	
340 CEDAR STREET SUDBURY ONTARIO P4A 1M6 TEL: 705-451-3300 FAX: 705-451-4210	
DRAWN BY: N.E.L.	DATE: OCT/9/02
CHECKED BY: T.S.A.	SCALE: N.T.S.
FIELD BOOK:	
OFFICE: SU-3395	PROJECT NO.: SU-3395
	DRAWING NO.: 2 of 2
	REV: 0



northland
engineering
(1987) limited
Consulting Engineers and Planners